

SIGNALINE

Signaline Water Detection Panel



CE

- Available as 2 or 4 zones
- 2 monitored sounder circuits
- Space for up to 3.2Ah batteries
- Up to 4000m of water detection cable monitored

LGM PRODUCTS LTD
UNIT 15 RIVERSIDE INDUSTRIAL PARK
FARNHAM
SURREY GU9 7UG
UNITED KINGDOM

TEL +44 (0) 1252 725257
FAX +44 (0) 1252 727627
E-mail sales@Lgmproducts.com
www.signaline.com



Signaline Water Detection Panel

CONTROL PANEL SPECIFICATION

Detection zones	2 zone or 4 zones of water detection cable.
End of Line device	4k7 Ohm 5% 0.25w resistor
IP rating	IP30
Operating temperature (°c)	-5°c to +40°c
Operating humidity	<95%
Standby current	75mA (2 zone) 85mA (4 zone)
Alarm circuits	2 fully monitored, each fused @500mA
Alarm load	800ma shared between all sounder outputs.
Common alarm relay	Volt free no/c/nc contact rated 3 amp @30 Vdc
Common fault relay	Volt free no/c/nc contact rated 3 amp @30 Vdc
External inputs	Class change and Alert pulse sounders Non latching switched -ve inputs. Max input voltage 28Vdc
Outputs	Water alarm and fault common outputs Switched -ve voltage outputs for external relay control, max load 40mA
Mains supply & fuse	230vac +10 / -15% 50Hz protected by 2 Amp fuse
Battery charging voltage	27.3 Vdc @20°C
Auxiliary supply to field accessories	28Vdc fused @ 500mA
Max. battery size & space	2 x 3.2Ahr 12volt VRLA (Use Yuasa NP range batteries)
Terminal capacity	0.5mm ² to 2.5mm ²
Cable entry	13 x 20mm top entry knockouts 7 x 20mm rear entry knockouts
Enclosure material and colour	Mild Steel, Epoxy powder coated silver grey Colour ref: Radon MW334E Interpon powder coat
Panel dimensions (mm W x H x D)	308 x 260 x 80

**LGM PRODUCTS LTD
UNIT 15 RIVERSIDE INDUSTRIAL PARK
FARNHAM
SURREY GU9 7UG
UNITED KINGDOM**

**TEL +44 (0) 1252 725257
FAX +44 (0) 1252 727627
E-mail sales@Lgmproducts.com
www.signaline.com**



Signaline Water Detection Panel

CONTROL PANEL SPECIFICATION continued

Front of panel indications

Zones in Water Alarm
Zones in Fault, Disabled or In Test Mode
Supply Healthy
General Alarm
General Fault
General Disablement
Test Mode
Sounder Status
Aux Output Status
Power Supply Fault
System Fault
Access Level

External Controls at access Level 2: (Access by key switch or code entry)

Colour coded buttons for controls and programming
Button functions: Resound alarms
Silence alarms
Reset
Disable Mode
Test Mode
Mute Buzzer
Test Lamps
Enter

External Controls at access Level 3: (Access by key switch or code entry)

Select sounder resound options for zones
View / edit dependency functions
Initialise factory settings
Set buzzer volume

LGM PRODUCTS LTD
UNIT 15 RIVERSIDE INDUSTRIAL PARK
FARNHAM
SURREY GU9 7UG
UNITED KINGDOM

TEL +44 (0) 1252 725257
FAX +44 (0) 1252 727627
E-mail sales@Lgmproducts.com
www.signaline.com



SIGNALINE

Signaline Water Detection Panel

Connection Schematic

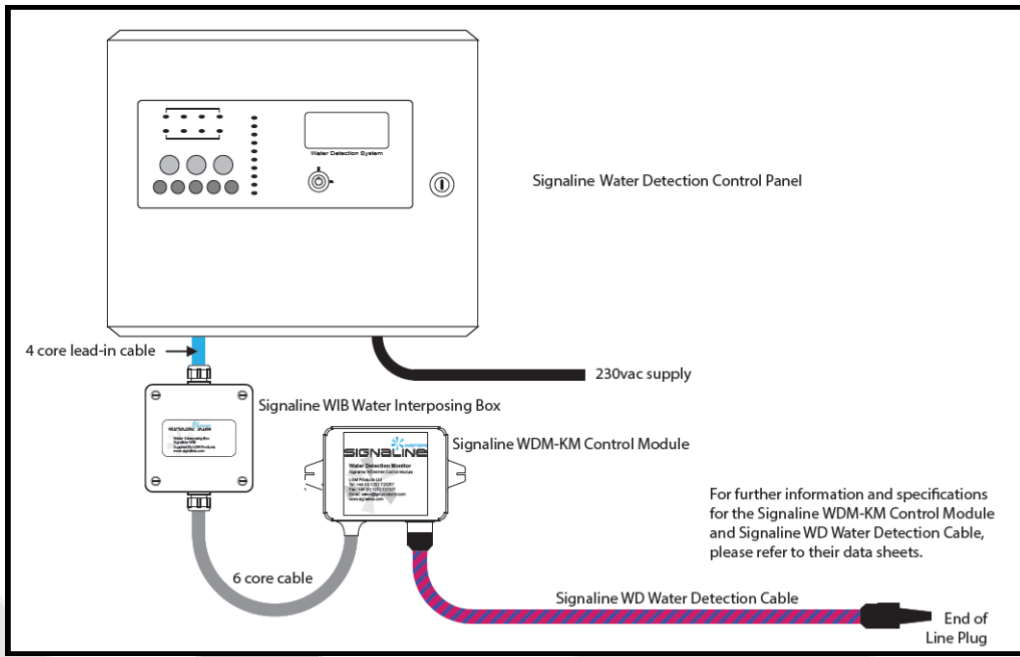

Dimensional Drawing

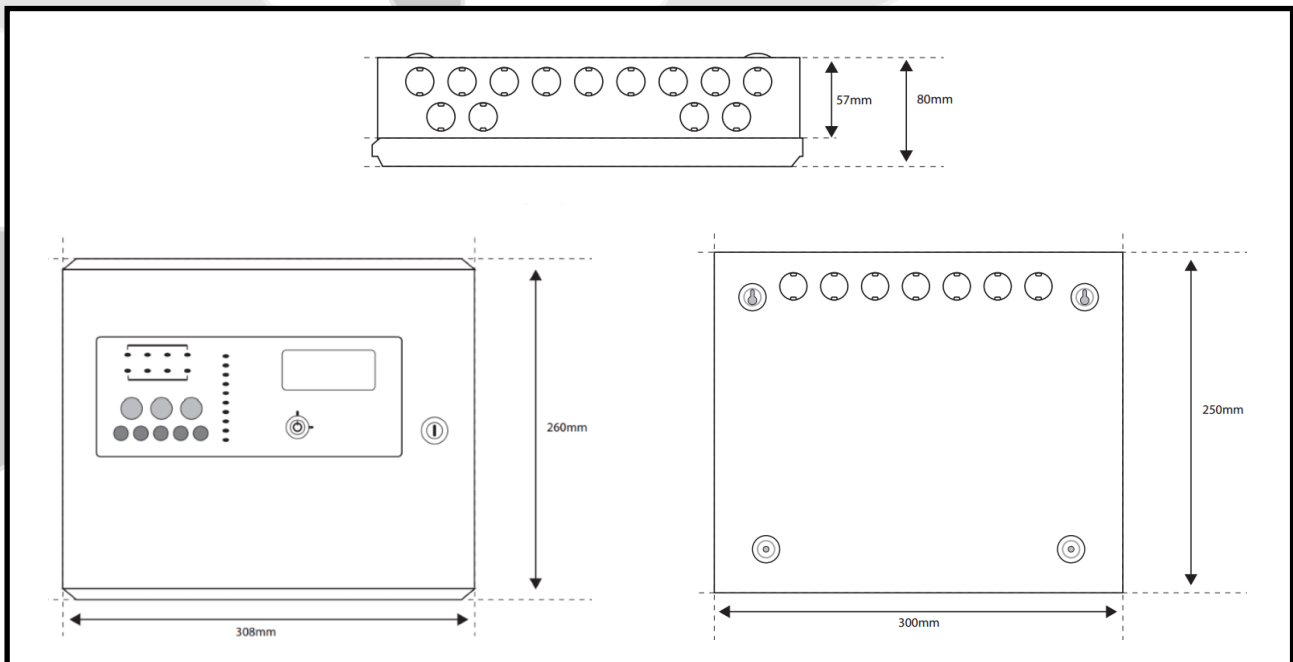

LGM PRODUCTS LTD
UNIT 15 RIVERSIDE INDUSTRIAL PARK
FARNHAM
SURREY GU9 7UG
UNITED KINGDOM

TEL +44 (0) 1252 725257
FAX +44 (0) 1252 727627
E-mail sales@Lgmproducts.com
www.signaline.com